

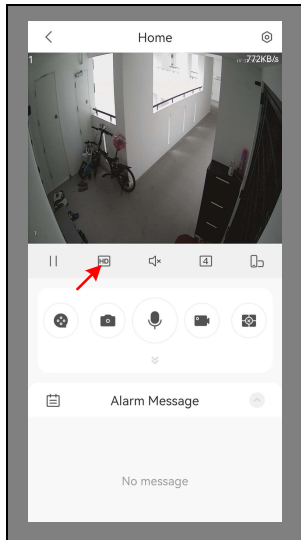

### High Resolution Liew View



Select the camera & click on HD

HD = High Resolution

SD = Low Resolution (Default)

### Stream Setting

Sub = Low Resolution (Default)

Sub stream are low resolution for slow network access

Main = High Resolution

1. Click ●●●

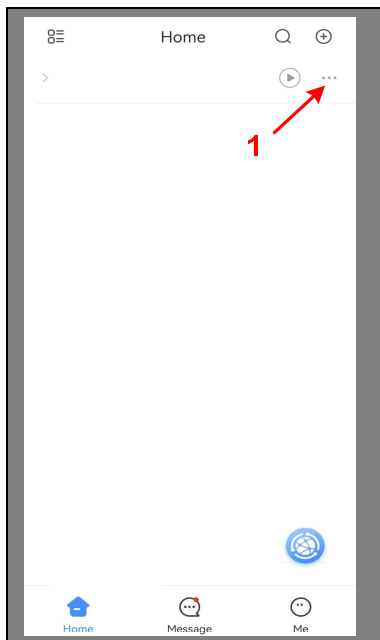

2. Click on Stream Setting

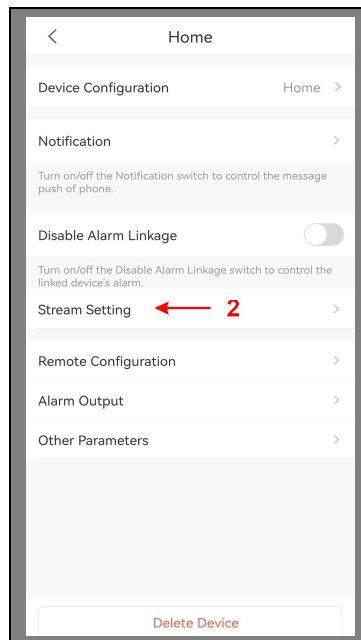

3. Change the Default Steam Setting

